



Instinct Guides You



Weston Road, Portland, Dorset DT5 2BZ £675 PCM

Registration No. 08079158 Directors Mr Wilson, Mr Tominey

Courtesy Notice Upon using WilsonTominey as selling agents ensure we are made aware of contractual obligations you may be under. We can then proceed accordingly.

WilsonTominey Ltd
15 Westham Rd.
DT4 8NS

T 01305 775500
E sales@wilsontominey.co.uk
W www.wilsontominey.co.uk



****VIDEO TOUR**** Pets Considered **TWO BEDROOM**, **GROUND FLOOR** flat in Weston, Portland, moments from shops and bus route.

The property, with **ALLOCATED PARKING** benefits from a **MODERN FITTED KITCHEN**, bathroom suite, large lounge/ diner and two bedrooms.

Entrance

Kitchen 10'2" x 9'10" (3.1 x 3)

Hallway

Lounge/ Diner 19'4" x 12'5" (5.9 x 3.8)

Bedroom One 9'10" x 9'6" (3 x 2.9)

Bedroom Two 9'10" x 7'2" (3 x 2.2)

Bathroom

Allocated Parking

Pet Charge

In the event a pet is considered for this property, there will be an additional charge of £25.00 per month, per pet. Please ask one of the members of our team whether a pet may be considered.

Pet Charge

In the event a pet is considered for this property, there will be an additional charge of £25.00 per month, per pet. Please ask one of the members of our team whether a pet may be considered.

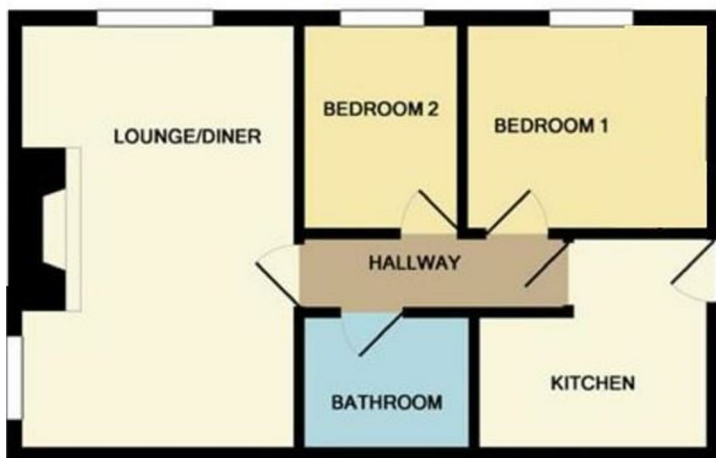

Energy Efficiency Rating		Current	Potential
Very energy efficient - lower running costs			
(92 plus) A			
(81-91) B			
(69-80) C			
(55-68) D			
(39-54) E			
(21-38) F			
(1-20) G			
Not energy efficient - higher running costs			
England & Wales		EU Directive 2002/91/EC	

Environmental Impact (CO ₂) Rating		Current	Potential
Very environmentally friendly - lower CO ₂ emissions			
(92 plus) A			
(81-91) B			
(69-80) C			
(55-68) D			
(39-54) E			
(21-38) F			
(1-20) G			
Not environmentally friendly - higher CO ₂ emissions			
England & Wales		EU Directive 2002/91/EC	

Important Notice: Particulars are prepared for marketing purposes only and should not be treated as a statement of the condition or suitability of any building, fixture or appliance. All measurements, floor plans and lease/ maintenance are approximate and not to be relied upon. Purchasers should make their own checks before relying on any of the information provided herein. * For double glazing and gas radiator heating, it is where specified.